

Price as Shown \$ \_\_\_\_\_  
 Includes delivery and anchored to  
 your slab  
 \*\*Prices Subject to Change\*\*

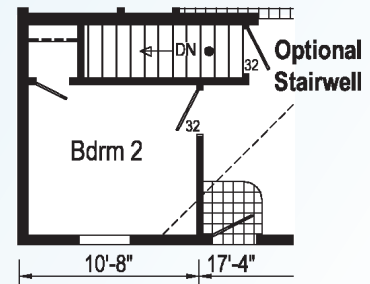

# The Trenton

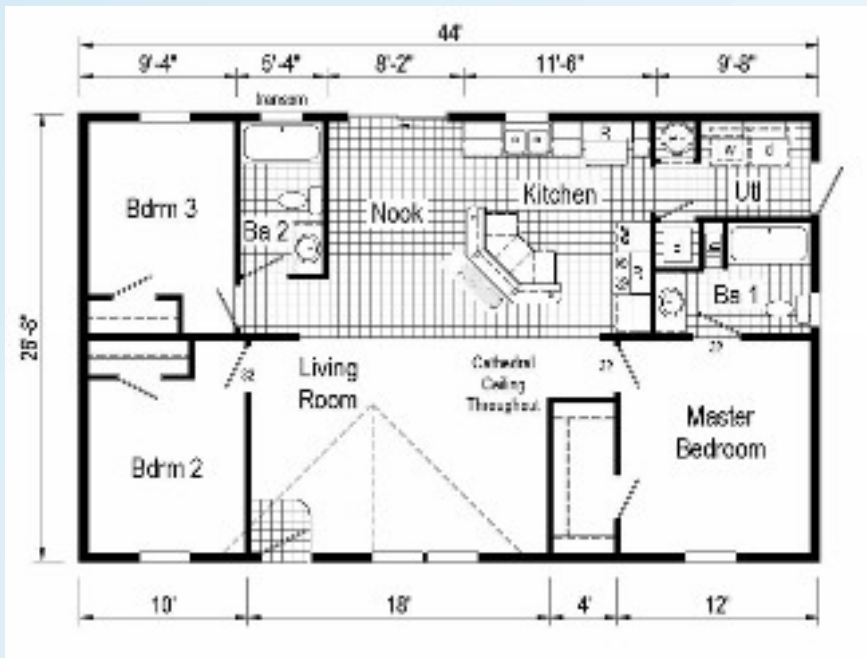

**26' x 44'**

**1173 Sq. Ft.**

## OPTIONS IN OUR MODEL

- 50 Gallon Electric Water Heater
- Gooseneck Pull Down Kitchen Faucet
- Half Lite Half Glass Fiberglass Rear Door
- 2 Storm Doors W/Sliding Screen
- Sliding Glass Door
- 24"X36" Bathroom Window – Master Bathroom
- 30"X9" Transom Window Over tub/shower Bathroom 2
- R-38 Ceiling Insulation
- R-22 Floor Insulation
- Marriage Wall Underlayment
- Lineal on all Windows
- Cathedral Ceilings
- 16" Eaves and Gable Ends
- Dormer 18'8" Flush Fixed
- Wind Wrap
- 200 AMP Service
- 2nd Conduit to Electric Panel
- White Paddle Fan – Living Room
- 2 LED Lights Flush Mount over Island
- Carbon Monoxide Detector
- Programmable Thermostat
- Contemporary Cabinet Pulls
- Kitchen Island XIB43
- 30" Cabinet and Wire Shelf over Laundry
- 30"X60" Shower – Master Bathroom
- Structured Flow Bath Faucets